

**GROUP 300  
COMPLEMENTS  
MOD. 310/69**

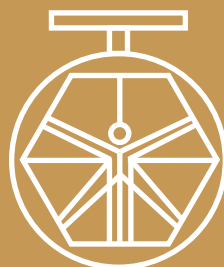

**DAVINCI  
VALVES™**

# **TECHNICAL DATA SHEET**

## **WATER Series**

**METALIC BELLOWS  
STAINLESS STEEL  
WELDING ENDS**

**DAVINCI  
VALVES™**



**QUALITY  
ASSUREMENT**

**DAVINCI  
VALVES™**



**PRODUCT QT  
ASSUREMENT**

**DAVINCI  
VALVES™**



**COMPANY QT  
ASSUREMENT**

[www.davincivalves.com](http://www.davincivalves.com)

18 Dongyu Street, Square One,  
11th Floor 1101, Jinjiang District,  
Chengdu, Sichuan CHINA

10F/Tower A, Billion Center,  
1 Wang Kwong Road, Kowloon Bay  
Kowloon HONG KONG

## METALIC BELLOWS WELDING END Ref.310A / PN 10-16

### APPLICATION:

Heating, air conditioning, cooling overheated water, fire protection systems, steam, etc.

### STANDARDS:

Design according to: EJMA 7th 2000.

Pressure Test: EN 12266-1, PED 97/23/EC:

Body: 24 bars.

Manufacture acc. to the requirements of the EU directive 2014/68/EU Equipment's under pressure: Cat. III mod. H.

### WORKING CONDITIONS:

Maximum Working Pressure: 16 bar.

Breaking Pressure: 32 bar.

Working Temperature: - 90 °C - + 400 °C.

directive 2014/68/EU Equipment's under pressure: Cat.

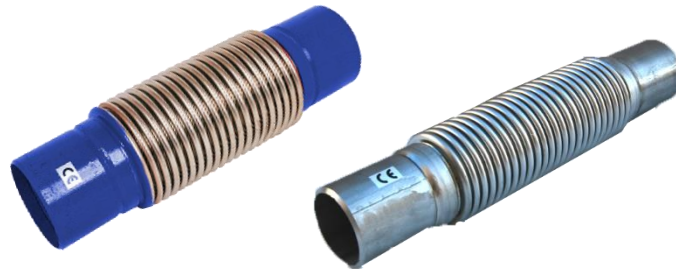

### GENERAL CHARACTERISTICS:

Designed to absorb axial dilatation movements, vibrations and slight misalignments in fluid conduction pipelines. Range from ND32 up to ND600.

Low load loss.

To work at high temperatures.

Reduced installation and maintenance cost.

Inner sleeve prevents deformations of the bellows.

| No | PART        | MATERIAL             |
|----|-------------|----------------------|
| 1  | WELD ENDS   | STEEL Q235 / AISI304 |
| 2  | BELLOW      | AISI304              |
| 3  | INNER LINER | AISI304              |

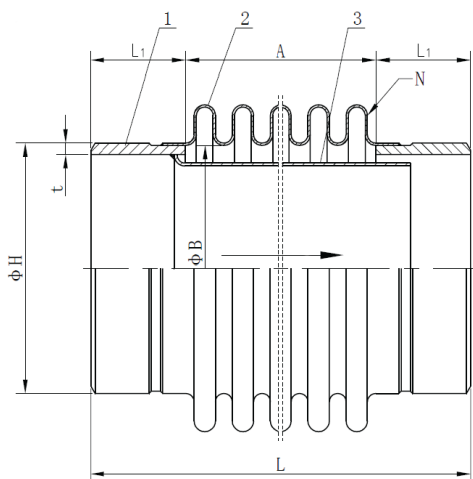

| ND  | L   | A   | ΦHxL <sub>1</sub> | B   | N  | Axial Movement |       |
|-----|-----|-----|-------------------|-----|----|----------------|-------|
|     |     |     |                   |     |    | Elong.         | Comp. |
| 20  | 250 | 120 | 27x2.5x65         | 25  | 24 | +5             | -25   |
| 25  | 250 | 120 | 34x3.0x65         | 32  | 21 | +5             | -25   |
| 32  | 350 | 180 | 42x3.0x85         | 40  | 30 | +10            | -30   |
| 40  | 350 | 180 | 48x3.0x85         | 50  | 25 | +10            | -30   |
| 50  | 350 | 180 | 60x3.5x85         | 60  | 20 | +10            | -35   |
| 65  | 350 | 180 | 76x3.5x85         | 76  | 17 | +10            | -35   |
| 80  | 350 | 180 | 89x4.0x85         | 89  | 17 | +10            | -40   |
| 100 | 350 | 180 | 114x4.0x85        | 114 | 11 | +10            | -40   |
| 125 | 350 | 180 | 140x4.0x85        | 140 | 11 | +10            | -40   |
| 150 | 350 | 180 | 168x5.0x85        | 168 | 11 | +10            | -40   |
| 200 | 350 | 180 | 219x6.0x85        | 219 | 8  | +10            | -40   |

| °C  | 50 | 100 | 150 | 200 | 250 | 300 | 350 | 400 |
|-----|----|-----|-----|-----|-----|-----|-----|-----|
| BAR | 10 | 9   | 8,5 | 7,5 | 7   | 6,3 | 5   | 4   |

*All the components can be substituted with equivalent or higher-class materials.*

DAVINCI VALVES LTD, is constantly looking at all ways of improving our products and services related to the water, fire and industry sector and therefore we reserve the right to change, without prior notice, any of the data contained here. Please contact our Technical Sales Department for detailed advice.  
© 2018 DAVINCI VALVES LTD.

www.davincivalves.com info@davincivalves.com +34 616553797 / +86 17340168233  
18 Dongyu Street, Square One 11th Floor 1101. Jinjiang District, Chengdu, Sichuan Province, China

*"For professionals who wants more"*

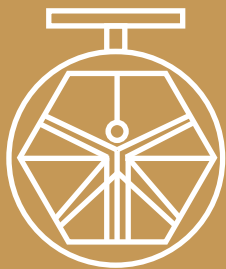

DAVINCI  
VALVES™

[www.davincivalves.com](http://www.davincivalves.com)